

The Vibe @

Summer 2010

The Graduate School of Biomedical Sciences

Greetings and welcome to The Vibe, a newsletter created with you in mind, a vehicle for communicating news about your alma mater and connecting you to your fellow alums. Twice a year, we'll let you know about new initiatives of the Graduate School of Biomedical Sciences (GSBS) and share ways that you can stay connected to both the institution and your classmates.

In this inaugural issue, you'll read about a new academic program in bioinformatics that will help shape future approaches to the management and analysis of molecular information generated in studies of biomedical research. You'll learn about construction of the school's newest and most ambitious facility, the Albert Sherman Center. You'll read about a fellow alum and learn about ways to reconnect with others. And we'll keep you informed about upcoming events on campus. You'll also learn about why your support is so important to the future of the GSBS and the students who follow you in their scientific pursuits.

We hope you enjoy The Vibe. If you have news you'd like to share or have suggestions for future issues of the newsletter, drop us a note at alumni@umassmed.edu or call the Office of Alumni Relations at 508-856-1593.

We look forward to hearing from you!
Sincerely,

Anthony Carruthers, PhD
Dean, Graduate School of
Biomedical Sciences



Zhiping Weng, PhD

Academic program in bioinformatics and integrative biology launched

AS EVER-INCREASING quantities of molecular information are generated in biomedical research, a pressing new challenge is understanding how to manage and analyze the vast amounts of data. This challenge has created a demand for new analytical approaches, leading to the rise of the interdisciplinary science of bioinformatics.

While the number of expert bioinformaticians in this emerging field is small, the number of students who are interested in graduate study in bioinformatics is, like the data sets they analyze, growing exponentially. Last summer, GSBS Dean Anthony Carruthers worked with Zhiping Weng, PhD,

the director of the Program in Bioinformatics & Integrative Biology that was established in 2008, and other faculty members to develop a corresponding academic program. The goals for the new program, which was launched in the spring, include creating a semester-long advanced bioinformatics course; creating an advanced topics course in evolution; mapping a strategy for recruiting students with backgrounds in mathematics, physics, chemistry, computer sciences and biology; and developing a core curriculum for bioinformatics students. ■

For more information about the program and the faculty, visit www.umassmed.edu/bbs/academics/bib.aspx.

CALENDAR OF EVENTS

JUNE

37th Commencement Ceremony

SUNDAY, JUNE 6, 2010

12 noon

Campus Green, UMass Medical School

UMass Comes To You

FRIDAY, JUNE 25, 2010

9 – 2:30 p.m.

Ocean Edge Resort & Golf Club, Brewster, MA

UMass Comes to You offers a series of short lectures on health care, current events and culture with some of the most prominent and accomplished faculty members from across the UMass system. \$50 per person includes continental breakfast, lunch and six lectures.

SEPTEMBER

Investiture

WEDNESDAY, SEPTEMBER 15, 2010

4 p.m.

UMass Medical School

Convocation

THURSDAY, SEPTEMBER 16, 2010

10 a.m.

UMass Medical School

Walk to Cure Cancer

SUNDAY, SEPTEMBER 26, 2010

12 noon

Aaron Lazare Medical Research Building
UMass Medical School

OCTOBER

Pink—Lighting the Way to a Cure

THURSDAY, OCTOBER 21, 2010

6 p.m.

Aaron Lazare Medical Research Building
UMass Medical School

UMass Memorial Children's Medical Center Starlight Celebration

SATURDAY, OCTOBER 23, 2010

Wagner Motors, Shrewsbury, MA

For more information about these events, contact the Office of Alumni Relations at 508-856-1593, email alumni@umassmed.edu or visit www.NetworkUMass.com/Medical.

The Albert Sherman Center: a foundation for the future

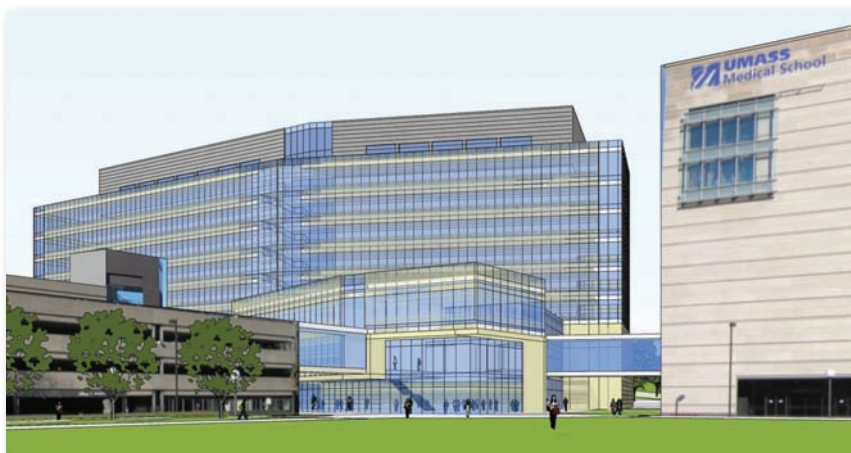

APRIL MARKED the beginning of a new era in life sciences discovery with the start of construction of the Albert “Albie” Sherman Center, a \$400 million state-of-the-art research and education facility on the northwest side of the Worcester campus. Slated for completion in 2012, the center will strengthen the Medical School’s competitive position as a leader in the life sciences and double its research capacity. Last year, the Massachusetts Life Sciences Center approved \$90 million in funding for the Sherman Center in recognition of the institution’s positive economic impact on the commonwealth. When fully operational, the Sherman Center is projected to support 1,600 jobs and \$264 million in annual economic activity throughout the state.

▲ Rendering of the Albert Sherman Center (provided by ARC/Architectural Resources Cambridge)

The Center will be an interdisciplinary research and education facility that will foster interaction and collaboration among scientists and across disciplines. It will incorporate new education space that fosters interdisciplinary learning, including the UMMS Simulation Center. The Sherman Center will also be home to the Advanced Therapeutics Cluster, which includes the RNA Therapeutics Institute, the Center for Stem Cell Biology and Regenerative Medicine and the Gene Therapy Center, and will provide research space for more than 100 investigators. ■



► Enthusiastic students worked the telephones during our spring Alumni Phonathon. Thank you to all who generously donated!

Ambulatory Care Center Opens

MEMBERS OF THE recently established Department of Quantitative Health Sciences became the first occupants of the 258,000-square-foot Ambulatory Care Center (ACC) when they moved into their seventh-floor space last fall. The ACC is located on the south side of the campus across from the main entrance to UMass Memorial Medical Center University Campus. The new facility was built to meet environmentally sustainable standards.

UMMS clinical partner UMass Memorial will relocate a number of ambulatory clinics to the

ACC, including centers of excellence for cancer, diabetes, heart and vascular and musculoskeletal, along with diagnostic testing services. The facility has been designed to speed the translation of research from bench to bedside. As a "Clinical Facility for Innovative Research and Education," it promotes interaction between clinicians and research faculty, and also includes dedicated space for a Clinical Research Center. Both of these research entities are joint ventures of UMMS and UMass Memorial. ■



▲ Ambulatory Care Center

Giving back

AS UMASS MEDICAL SCHOOL Graduate School of Biomedical Sciences alumni reflect upon and benefit from the excellence of their education, they often demonstrate their gratitude by generously supporting the school through donations to the GSBS Annual Fund. Alumni support is critical and helps build the foundation for future generations of graduates to become valuable contributors to the world of biomedical science through groundbreaking research discoveries and education.

The GSBS Annual Fund helps to provide advancements to research technologies and educational equipment that make us a national leader in research education. The GSBS Annual Fund also provides support for student professional development programs.

With less than 10 percent of UMass Medical School's budget coming from the state, philanthropic contributions are essential. Every gift, no matter the size, has an impact. Please consider joining your GSBS friends and alumni in supporting the Alumni Annual Fund Campaign. ■

ALUMNI ANNUAL FUND CAMPAIGN

UMass Medical School recognizes donors to its Alumni Annual Fund Campaign at the following leadership levels. These levels of giving are based upon cumulative gifts received during each fiscal year, beginning July 1.

Founder	\$10,000+
Partner	\$5,000-\$9,999
Patron	\$2,500-\$4,999
Benefactor	\$1,000-\$2,499
Friend	\$500-\$999

The Heritage Society recognizes donors who support UMass Medical School through bequests, life-income gifts, retirement plans, life insurance policies and other estate intentions.

You may make a secure online gift at www.umassmed.edu/foundation/onlinegiving or send your contribution to the UMass Medical School/UMass Memorial Development Office, 333 South Street, Shrewsbury, MA 01545.

Alums give back through the Career Development Seminar Series

AS PART OF A Career Development Seminar Series sponsored by the Office for Postdoctoral Scholars, GSBS



alumnus Dan Young, PhD '05, recently led a career information discussion relating to opportunities in intellectual property law for students and postdocs on the UMMS campus. After completing his PhD

research in molecular mechanisms of tissue-specific gene regulation in 2005, Dan did his postdoctoral work at the Novartis Institutes for BioMedical Research and the Department of Systems Biology at Harvard Medical School. He is now a patent agent with Wolf, Greenfield & Sacks, P.C. His work includes assisting clients in patent prosecution and IP due diligence primarily in the areas of biotechnology and biomedical research. Dan is also pursuing a J.D. at Suffolk University Law School in Boston. Dan lives in Hingham, Mass., with his wife, Leigh, and their three children. Dan and Leigh are expecting their fourth child in July. ■

Office of Alumni and Parent Relations
333 South Street
Shrewsbury, MA 01545

Address Service Requested

Non-profit Org
US Postage
PAID
Worcester, MA
Permit No. 176



The Graduate School of Biomedical Sciences

Office of Alumni and Parent Relations
Diana Tsotsis, Director
333 South Street
Shrewsbury, MA 01545
alumni@umassmed.edu
508-856-1593
www.NetworkUMass.com/Medical

To submit information to be
considered for this newsletter, send
an e-mail to alumni@umassmed.edu.

*This is a publication of the University
of Massachusetts Medical School Office
of Alumni and Parent Relations. It is
produced on behalf of Alumni and
Parent Relations by the Office of Public
Affairs and Publications.*

Alumni Profile



Name: Susan Heilman, PhD
Program: Interdisciplinary
Graduate Program
Year of Graduation: 2007

For SUSAN HEILMAN, her degree in biomedical sciences has led to a unique career at the Museum of Science in Boston. She works in the Current Science and Technology Program, giving fun and accessible presentations on current science. Sometimes a live animal is involved, as was the case when a three-foot alligator named Franklin was introduced during a discussion about new studies of the alligator immune system, which in some ways is better than a human's. She produces the weekly museum podcast, appears monthly in a live broadcast on NECN and also organizes various museum events related to current science topics. "I also bring in guest researchers all the time and am always looking to the UMass community to supply people for me," she said. "Oh yeah, and I can work the Van de Graaff generator at the museum and create

my own indoor lightning storm! I have a great job," she added.

Susan is married to Destin Heilman, PhD '06, who is an instructor in chemistry and biochemistry at WPI. They spend a lot of time working on their house in Southborough. In addition to seeing close friends from her GSBS days regularly, Susan stays in touch with other alums, current students and employees through social media vehicles, and e-mail. ■

Anyone with news to share is encouraged to send their class notes to alumni@umassmed.edu. You may also submit notes by visiting the UMass Alumni Online Community at www.NetworkUMass.com/Medical and click on "Class Notes."